



## IRH-TSB001/TSW001 Series WiFi Thermostat

User Guide



### For Electric Heating

### Thermostat Colors:

001FB: full black                      001BW: black and white  
 001FW: full white                      001WB: white and black

### Welcome

Thank you for your purchase.

Your new thermostat will provide uniform and comfortable temperature control throughout every room in your property. We bring together technology, craftsmanship and the highest quality materials to provide you with a safe, reliable product combined with sleek, contemporary design.

Please read this installation/programming manual for comprehensive instructions on installing and operating your thermostat. Please also ensure a suitably qualified person installs your thermostat and complies with all local regulations.

### In the box you will find

|            |     |                            |     |
|------------|-----|----------------------------|-----|
| Thermostat | 1pc | Screws                     | 2pc |
| User Guide | 1pc | Floor Sensor (2.5m)        | 1pc |
| QC Passed  | 1pc | (Floor sensor is Optional) |     |

### ABOUT YOUR THERMOSTATS

The IRH-TSB001/TSW001 series range has been developed to control electric underfloor heating systems. These units are designed for use in commercial, industrial, civil ad domestic properties.

### MODEL DEFINITION

T: Thermostat  
 S: Square Shape  
 R: Round Shape  
 W: White color  
 B: Black color  
 001/002/003 - Model

### FEATURES

#### On Appearance

1. Convenient operation creates convenient life.
2. Options of black and white housing.
3. Fashion design blends in with any decor.
4. Touch Screen display with backlight is easy to read, even in the dark.
5. Bright buttons always remind you the world truly exist.
6. Easy UI interface could be used even by child.

#### On Functionality

1. Powerful fuctions are available such as Modbus/WIFI etc.
2. 0.5°C Accuracy keeps temperature within the level you set.
3. Data memory when power is off.
4. 5+2 six periods programmable maximize comfort and economy.
5. Creat thermostat group to Centralized control
6. Interated with Amazon Echo ,Google Home.
7. All setting languages synchronize your time zone, address and language.
8. No limit to add rooms and support Smart Scene.

### DIMENSION

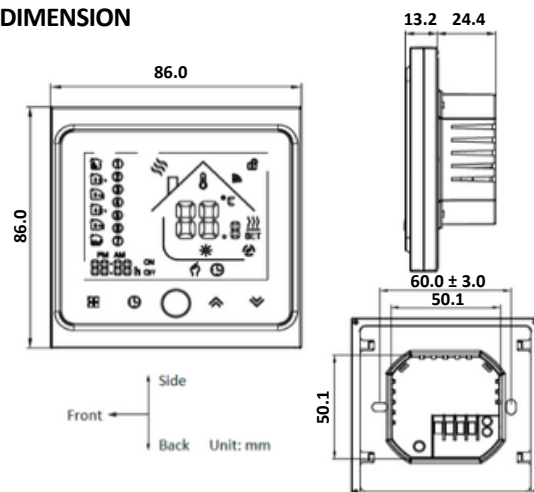

### TECHNICAL DATA

Power Supply: 95 ~ 240 VAC, 50 ~ 60HZ  
 Current Load: 16A (electring heating)  
 Sensor: NTC  
 Accuracy: ±0.5 °C or ±1 °F  
 Set Temp. Range: 5 - 35 °C  
 Display Temp. Range: 5 ~ 99 °C  
 Ambient Temp.: 0 ~ 45 °C  
 Ambient Humidity: 5 ~ 95 % RH (Non Condensing)  
 Storage Temp.: -5 ~ 45 °C  
 Power Consumption: <1.5W  
 Timing Error: <1%  
 Shell Material: PC +ABS (flame retardant)  
 Installation Box: 86 \* 86 mm Square or European 60 mm Round Box  
 Wire Terminals: Wire 2 x 1.5 mm<sup>2</sup> or 1 x 2.5 mm<sup>2</sup>  
 Protection Class: IP20  
 Buttons: Capacitive Touch Buttons

### BEFORE WIRING AND INSTALLING

1. Read these instructions carefully. Failure to follow them could damage the product or cause a hazardous condition.
2. Check the ratings given in the instructions and on the product to make sure the product is suitable for your application.
3. Installer must be a trained, experienced service technician.
4. After installation is complete, check out product operation as provided in these instructions.



### CAUTION

**Electrical Shock or Equipment Damage Hazard. Can shock individuals or short equipment circuitry.**

**Disconnect power supply before installation.**

### WIRING

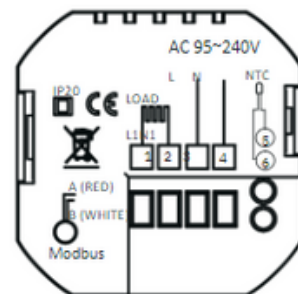

Note:

NTC and Modbus is optional

### INSTALLATION

Your thermostat is suitable for installation within a standard 86 mm pattress box or European 60 mm pattress box.

Step 1. Keep power off. See Fig 1.

Step 2. Slide the LCD assembly down to remove the mounting plate. See Fig 2.

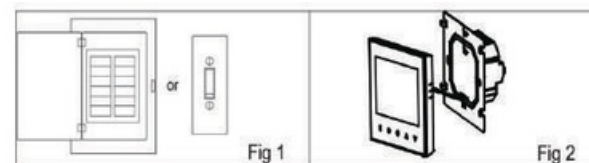

Step 3. Connect power supply, load into the appropriate terminals. (See "Wiring your thermostat" for details and Fig 3).

the box. See Fig 4.

Step 4. Fix the mounting plate into the wall with screws in the box. See Fig 4.



Step 5. Fasten body of thermostat and the mounting plate through rotating. See Fig 5.

Step 6. Installation complete. See Fig 6.

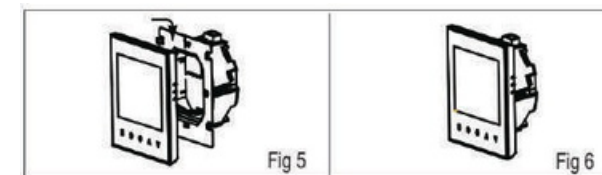

### HOME SCREEN QUICK REFERENCE

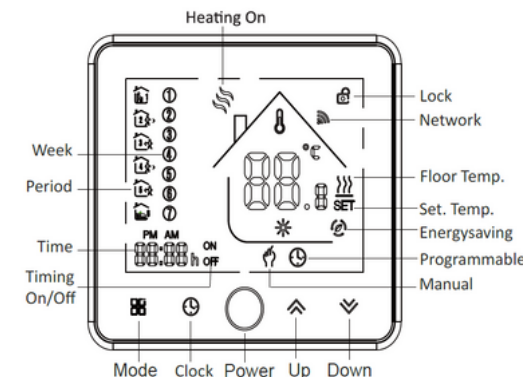

### OPERATION

#### During Power On

1. **Power on/off:** Press to turn the thermostat on/off

#### 2. Manual & Programmable

Touch (mode) to change between manual mode and programme mode. In the manual mode, will display in the bottom of the screen. In programmable mode, the period icon will show in the left side.

#### 3. Setting Temperature

In the mode of programmable, set temperature, time and timing on/off could not be adjusted. If the user want to change, please go to manual mode or programmable mode.

In the mode of manual, press to set the desired temperature.

#### 4. Adjusting/Setting the Clock

Touch the icon to set minute, hour and weekday (1=Monday, 2=Tuesday etc.) by using the arrows. Press once more to confirm and exit.

#### 5. Locking your Thermostat

Press and hold the for 5 seconds to lock/unlock your thermostat. In item 3 of high senior options, you can select full lock or half lock.

#### 6. Adjusting/setting the Program Schedules

When Wi-Fi connection is made, your thermostat will automatically accept the program schedule made via the APP on your device (see below for detailed instructions). To set the program schedules through your thermostat (NOT via your smartphone/tablet) simply follow the instructions as below:

**Please note: Setting the programme schedule through your thermostat can only be carried out if there is no Wi-Fi connection between your thermostat and smartphone/tablet.**

Touch to change between manual mode and programme mode.

In the manual mode, will display in the bottom of the screen.

In programme mode, touch and hold the icon until the weekday schedule settings appear (1 2 3 4 5 will show along the left of the screen).

Use the and arrows to adjust the on time.

Press the icon and use the and arrows to set the off time (2nd period). Press the icon and use the and arrows to set the temp.

Repeat this process for periods 3 4 and 5 6.

Press the icon' once more to enter the Saturday schedule settings (6 will show along the left of the screen).

Repeat the above process to set the period and temp. and Sunday schedule.

Press once more to confirm and exit.

### Default settings for program schedule

| Time display  | WEEKDAY (MONDAY – FRIDAY)<br>(1 2 3 4 5 shows on screen) |             | WEEKEND (SATURDAY)<br>(6 shows on screen) |             | WEEKEND (SUNDAY)<br>(7 shows on screen) |             |
|---------------|--|-------------|---|-------------|---|-------------|
|               | TIME   | TEMPERATURE | TIME                                      | TEMPERATURE | TIME                                    | TEMPERATURE |
| Period 1      | 06:00  | 20°C        | 06:00                                     | 20°C        | 06:00                                   | 20°C        |
| Period 2      | 08:00  | 15°C        | 08:00                                     | 20°C        | 08:00                                   | 20°C        |
| Period 3      | 11:30  | 15°C        | 11:30                                     | 20°C        | 11:30                                   | 20°C        |
| Period 4      | 13:30  | 15°C        | 13:30                                     | 20°C        | 13:30                                   | 20°C        |
| Period 5(1+2) | 17:00  | 22°C        | 17:00                                     | 20°C        | 17:00                                   | 20°C        |
| Period 6(3+4) | 22:00  | 15°C        | 22:00                                     | 20°C        | 22:00                                   | 20°C        |

A separate schedule may be set for weekdays (Mon - Fri) and for weekends (Sat or Sun).

### 7. Checking the Temperature of Floor Sensor

Press and hold the arrow for 5 seconds to display the temp. of floor sensor.

### 8. Return To Factory Default

Press the **Reatore Manufacturer defaults**, you can reset thermostat.

Steps: Open your app - go into your room - click menu on the top right corner - move to the end - Press **Restore Manufacturer Defaults**.

### During Power Off

#### Setting the Functions and Options

When power is off, press and hold and at the same time for 5 sec. in order to reach system function. Then press to scroll through the available functions, and use the and arrows to change the available options. All settings are confirmed automatically.

| Code | Function                             | Setting and options   | Default |
|------|--------------------------------------|---|---------|
| 1    | Temperature compensation             | -7 to +7°C ( for internal sensor)   | -1      |
| 2    | Deadzone Temperature                 | 1~ 5°C  | 1       |
| 3    | Button locking                       | 00: All buttons are locked except power button.<br>01: All buttons are locked.  | 01      |
| 4    | Sensor types                         | In: Internal Sensor (to control or limit the temp.)<br>Ou: Only external sensor<br>Al: Internal/External Sensor (Internal sensor to control the temp. external sensor to limit the temp.) | AL      |
| 5    | Min. Set Temp                        | 5-15°C  | 05      |
| 6    | Max. Set Temp                        | 15-45°C   | 35      |
| 7    | Display Mode                         | 00: Display both set temp. and room temp.<br>01: Display set temp. only   | 00      |
| 8    | Low temperature protection setting.  | 0-10°C  | 00      |
| 9    | High temperature protection setting. | 25-70°C   | 45      |
| A    | Economy Mode                         | 00: Non-energy saving Mode<br>01: Energy saving mode  | 0       |
| B    | Economy Temp.                        | 0-30°C  | 20      |



## WI-FI CONNECTION

Before using your Wi-Fi thermostat for the first time, you must configure the Wi-Fi signal and settings through your smartphone or tablet. This will allow communication between your connected devices.

Step 1. Download your APP (Fig 1-1)



Fig 1-1



Fig 1-2 IOS



Fig 1-3 Android

Search for "Smartlife" in Apple Store or Google Play or use a browser to scan the QR code above (Fig 1-2), and complete account registration and installation according to the guidance of the APP.

Step 2. Connect the thermostat

Check the tutorial below to

Method 1: Scan the QR code to configure the network guide (Fig 2.1 - Fig 2.3)

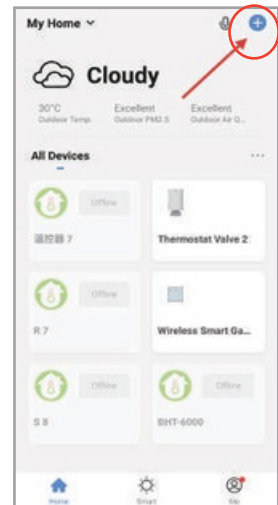

Fig 2.1

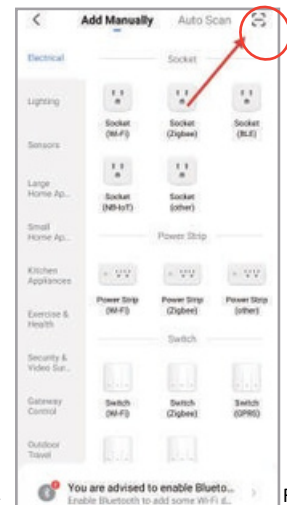

Fig 2.2



Fig 2.3

Method 2: Ordinary distribution network guidance (Fig 2.1 & Fig 2.3.1)

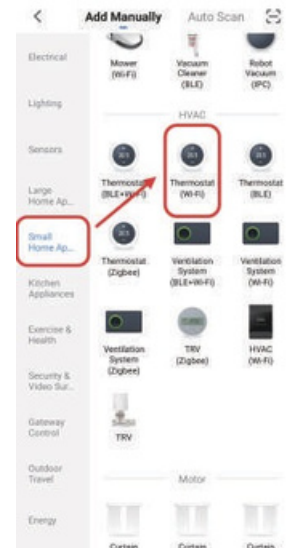

Fig 2.3.1

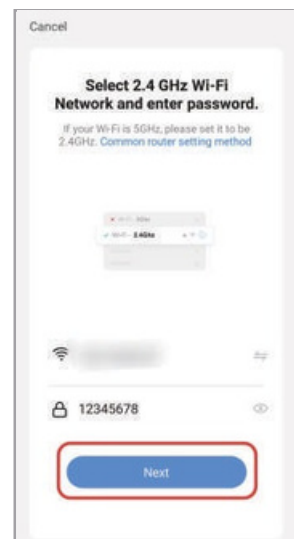

Fig 2.5

## Network distribution mode:

1. EZ Mode

When the thermostat is off, press and hold the until the thermostat screen flashes quickly and displays the and then operate according to the following figure (Fig 2.4 - Fig 2.7).



Fig 2.4

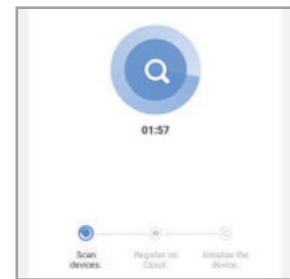

Fig 2.6

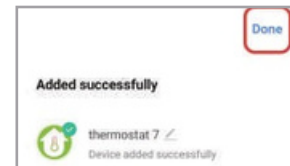

Fig 2.7

2. AP Mode

When the thermostat is off, press and hold the until the thermostat screen flashes slowly and the is displayed (if the appears, continue to press the until the thermostat screen Flashes slowly and displays the ), and then operate according to the following figure (Fig 2.8-Fig 2.14)

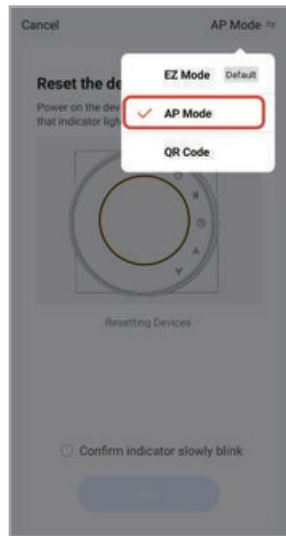

Fig 2.8

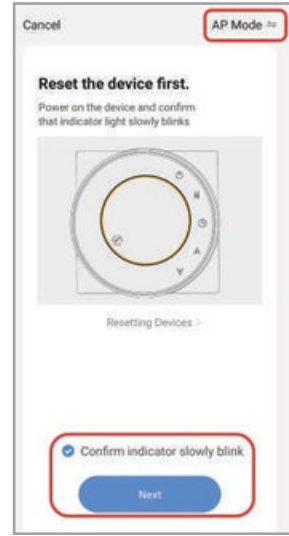

Fig 2.9

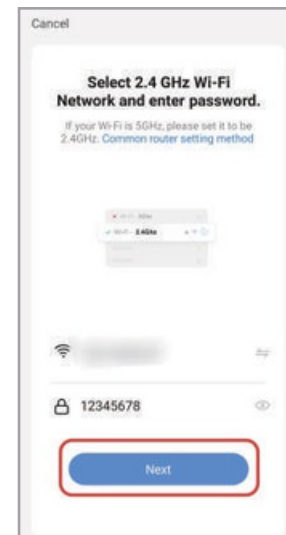

Fig 2.10

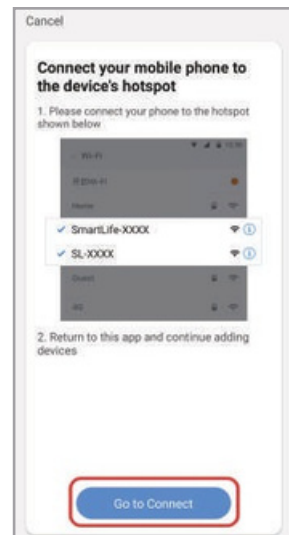

Fig 2.11

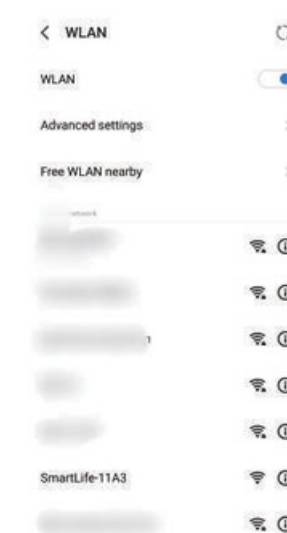

Fig 2.12

After connecting to this hotspot, return to the "smartlife" APP

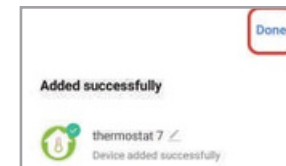

Fig 2.14

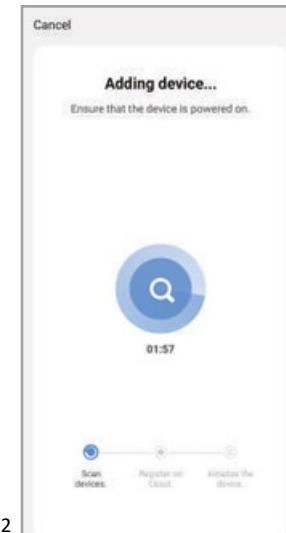
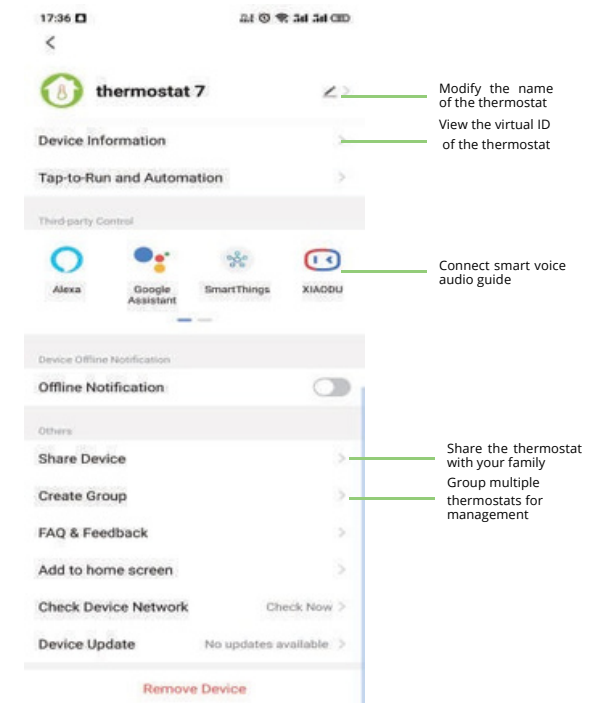
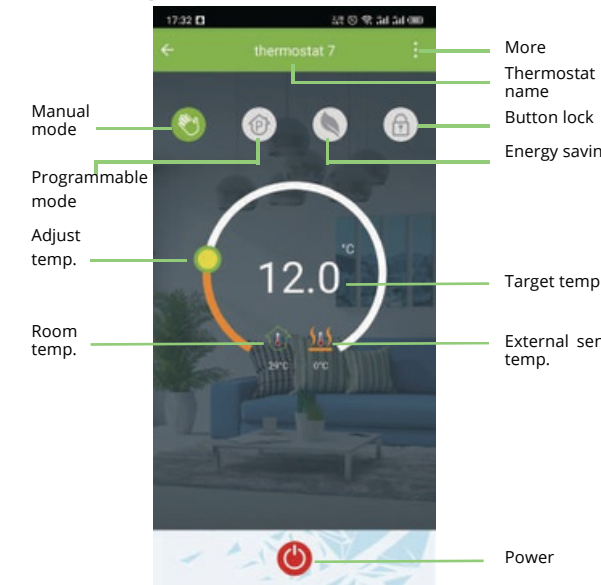

Fig 2.13

## More settings



## APP operation interface description (heating thermostat)



## SIMPLE EXCEPTION HANDLING

| No. | Phenomenons                                       | Handling   |
|-----|---|--|
| 1   | Power is on but without display.                  | * Check if the terminals between LCD panel and Power Unit Box is loosen. |
| 2   | Without output but display works.                 | * Use a new LCD panel or new Power Unit Box to replace the old one.      |
| 3   | Room Temp. Is a little different from the actual. | * Do temperature calibration in item 1 of high senior options            |

## SERVICE

Your thermostat carries and 24 months warrant from date of purchase. Service outwith the warranty period may incur a charge. More detail please contact with us directly.



Scan this QR code